

Crete Tie WALLFAST Limited

For tying light weight thermal blocks to masonry bed-joints.
Forming cavities using thin joint block construction systems.
Tying cavities and abutting walls bed-joints to thermal blocks.

Installation Procedure

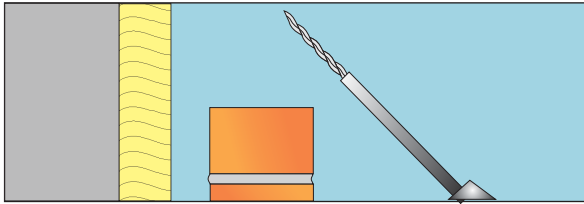

(1) Insert tie into support tool.

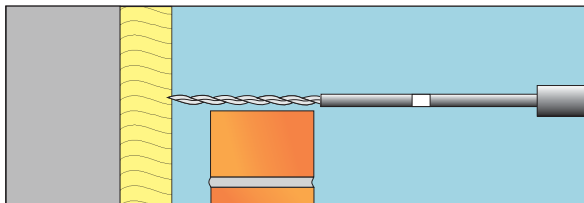

(2) Position tie where required and level with outer mortar bed.

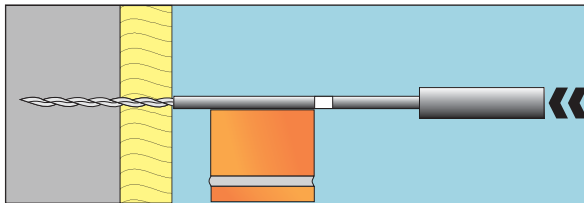

(3) Hammer tie through insulation and into Air-Crete Blocks then fit retaining Clip.

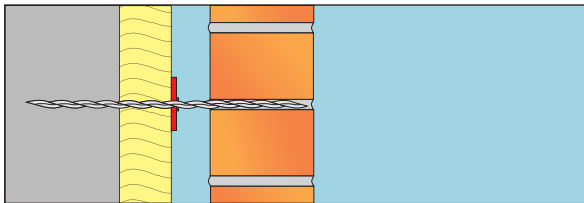

(4) Embed outer tie end in mortar of outer leaf masonry.

Crete Tie has been approved for use, by leading light weight block manufacture's Celcon, Thermalite and Durox

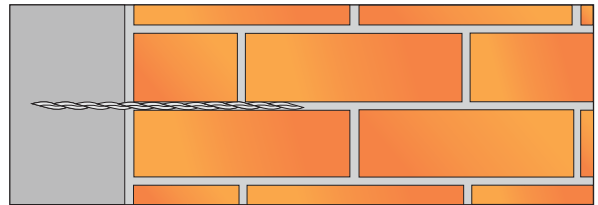

Adding abutted masonry walls to light weight thermal blocks.

Benefits

- ✓ Quick installation.
- ✓ Lateral flexibility over cones any misalignment.
- ✓ Allows for close to edge fixing.
- ✓ Allows for thermal movement.
- ✓ Multi water drips.
- ✓ Easy installed through cavity insulation.
- ✓ Designed and tested to DD140.
- ✓ Stress free fixing.

Features

- ✓ Easy and problem free installation.
- ✓ Austenitic 304 or 316 Stainless Steel.
- ✓ Effective in tying cavity and solid walls.
- ✓ Small cross area gives good sound proofing.

Crete tie classification DD140

Tie Size	Tie density	Laid in Mortar 70mm	Fixed in Blocks 90mm
Ø8mm	2.5m ²	Class 2	Class 4
Ø8mm	3.4m ²	Class 2	Class 3
Ø8mm	5.0m ²	Class 2	Class 2

Crete tie length selection

Cavity mm	Tie Length mm
50	220
75	245
100	270
125	295